



Connor Fitzgerald and Louie Zalk-Neale,
Pause *Blur Grass Witch* | Workshop, 2021.
Photo: Bunty Bou.

Blue Oyster Exhibitor Info

Key Contact

Hope Wilson | Director
03 479 0197 | 027 345 3017
director@blueoyster.org.nz

Gallery

Location

Blue Oyster Art Project Space is located on 16 Dowling Street Dunedin.

Gallery One

Exhibition space is 9.6 x 4.2 metres with a ceiling height of 3.3 metres. The gallery walls are 12mm MDF and the floor is wooden. Gallery One has a large window that faces the street.

Gallery Two

Exhibition space is 4.9 x 2.8 metres with a ceiling height of 3.3 metres. The walls are 12mm MDF. Gallery Two has no windows and a single entrance.

Both galleries have fluorescent lighting in fixed positions. Please download the Floor Plan from the Blue Oyster website.



Gallery One: Arielle Walker, *Distance* reworked from the roots to the stem, 2021. Photo: Bunty Bou.



Gallery Two: Turumeke Harrington, *SPECIAL TIME (Ehara i te ti)*, 2021. Photo: Bunty Bou.

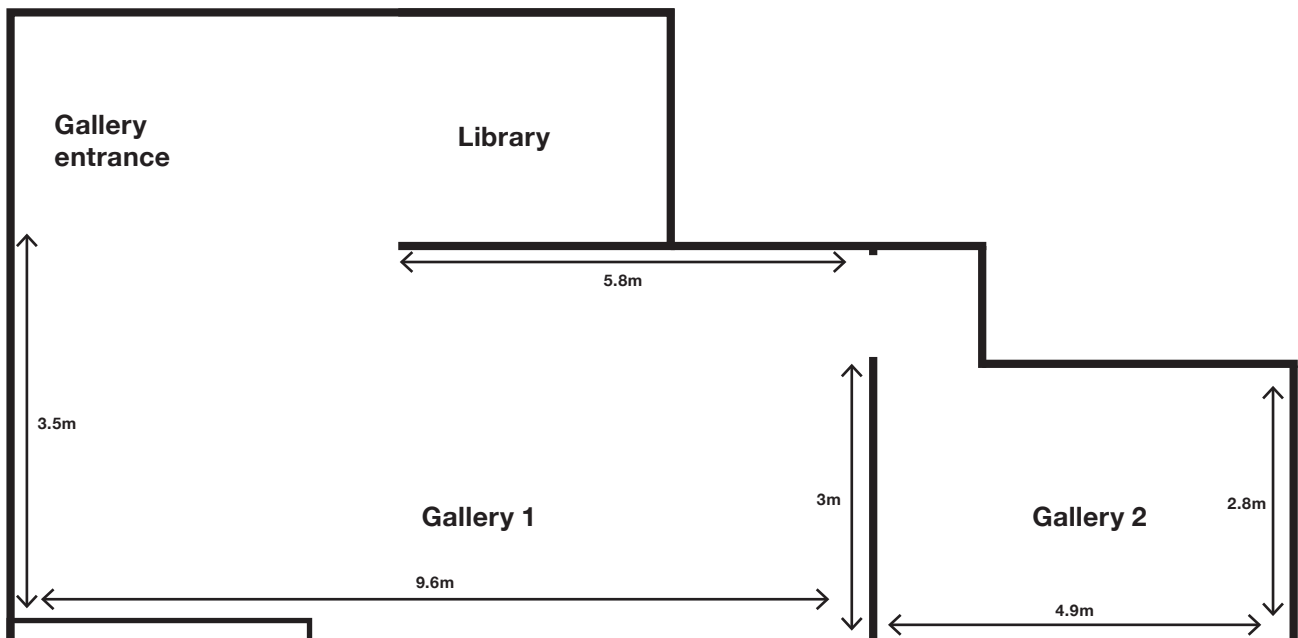

Expectations & Fees

If your project is accepted for the 2022 programme, the Director will work with you to find an appropriate exhibition slot between January-December for your project. In most cases, exhibition install will take place Monday-Thursday with the exhibition opening scheduled for Thursday at 5.30pm. Exhibitions run for five weeks.

Programmed artists receive a \$750 artist fee as well as \$500 towards production costs. Blue Oyster has a limited budget for flights and accommodation and will also contribute \$200 towards return freight.

Context

Founded in 1999, the Blue Oyster Arts Trust is the governing body of the Blue Oyster Art Project Space, a not for profit art space located at 16 Dowling Street, Dunedin. All exhibitions and events are free to attend, the space offering an environment of criticality, support and learning.

Blue Oyster Art Project Space exists to enable emerging and experimental artists, writers, curators and arts practitioners to work free from commercial restraints in an innovative and experimental environment.

Blue Oyster's staff and board are committed to working with artists to present their work in a way that is accessible, fair, and aims to broaden public interest and understanding of contemporary art.

We are supported by Creative New Zealand and the Dunedin City Council, along with a range of other sponsors, funders, patrons and supporters in and around the Dunedin community.

Public Programme

Blue Oyster has a dedicated Public Programme Coordinator who will collaborate with you to develop and deliver relevant events and materials alongside your project. The public programme could take many forms, including a talk, performance, collaborative making session or screening. We

are committed to a collaborative and supportive approach to the development and delivery of an experimental and tailored public programme.

Installation

Blue Oyster does not have an in-house gallery technician but can provide advice on any construction or technological requirements or arrange a contractor to support install, if required.

Basic tools are provided by Blue Oyster and we have speakers, screens and digital projectors, and media players available for exhibitors to use on request.

Accessibility

Blue Oyster has limited physical access. There is a small step in the gallery entrance and three steps in a narrow passage to the bathroom. If you would like more information about our space or have any accessibility requirements or queries you would like to discuss, please contact the gallery.

Safe Space

Blue Oyster is committed to providing an inclusive and respectful safe space for arts practitioners and visitors. We do not tolerate violence, bullying, or hate speech.

Promotional Material

Blue Oyster has a dedicated Design, Communication, and Publication Manager who will work with you to develop the design for the poster, exhibition pamphlet, press release, and social media roll out. Blue Oyster produces and distributes promotional material for each exhibition. We require basic information and images at least four weeks prior to the opening. Your exhibition will be shared

through our website, e-newsletter, and social media.

Annual commissioned text

Blue Oyster commissions a text response to each exhibition which is published in our Annual and our website. The writing can take a range of forms—creative, non-fiction, poetic, critical—and can be commissioned prior to the exhibition and printed in the room sheet or could be a response which happens after the exhibition is installed.

Gallery staffing

Exhibitions are monitored by staff and an amazing team of volunteers. Open hours are Tues-Fri 11am-5pm & Sat 11am-3pm. We record visitor attendance throughout the exhibition for reporting purposes.

Documentation

Blue Oyster will commission a photographer to document the exhibition. This documentation will cover basic installation views, however it is the responsibility of the artist to communicate any specific views or details they would like documented. Images are available for artist use and will be published on our website and social media with artist consent.

Deinstall

Blue Oyster Staff will deinstall the work the day following the exhibition closing. It is the responsibility of the artist to provide a detailed plan for deinstall, packaging, and freight for the work.

Survey

Artists are asked to respond to a short practitioner survey at the conclusion of the exhibition. This response may be used in our reporting to funders.



Image: Miranda Bellamy & Amanda Fauteux, *radiata*, 2021.
Photo: Bunty Bou.



Image: Luke Shaw & Phoebe Hinchliff, *Between a Hawk and a Mountain*, 2021.
Photo: Jonas Jessen Hansen.

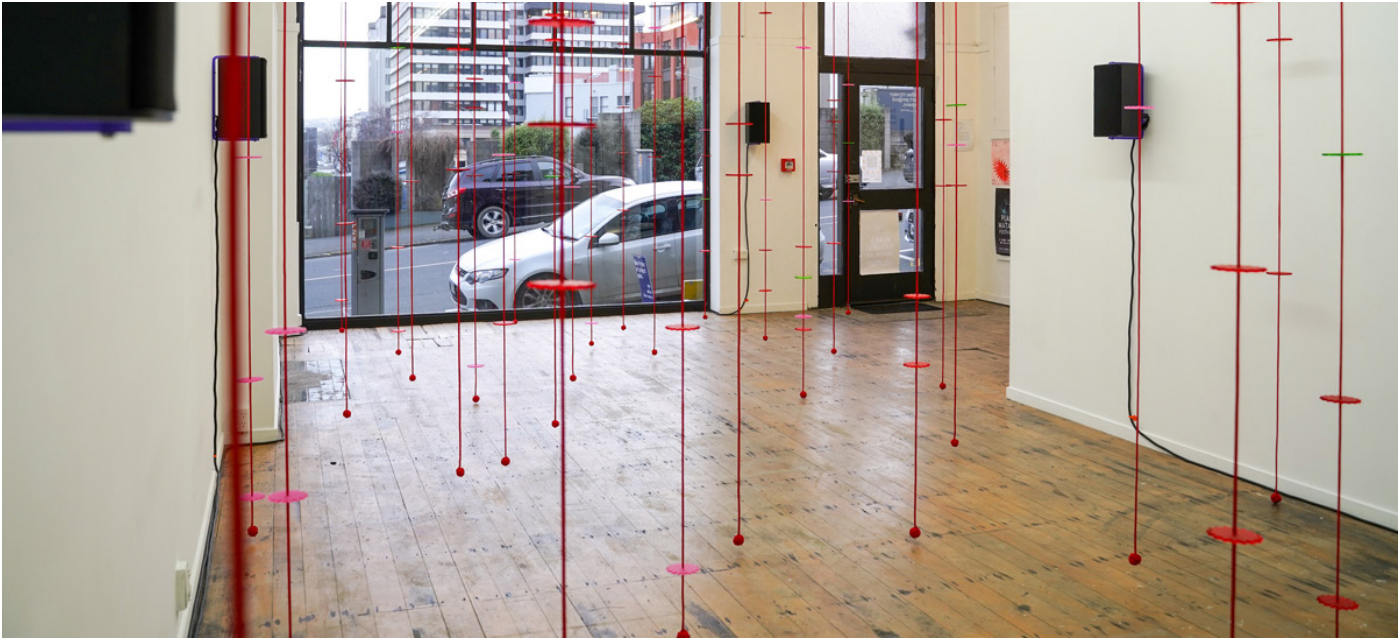

Image: Turumeke Harrington, *SPECIAL TIME (Ehara i te ti)*, 2021.
Photo: Bunty Bou.